

Panasonic

Operating Instructions

SUPER MIXER GRINDER

Model No. **MX-AC300**
MX-AC220
MX-AC210



Thank you for purchasing the Panasonic product.
Please read these Instructions carefully before using this product and save this manual for future use.
This product is intended for household use only.

Table of contents

Before Use

Safety Precautions	2
Differences among three models	4
Parts Identifications	
Safety Lock	5

How to Use

How to Assemble / Disassemble	6
How to Use	
Guide to Functions	8

To Use Long Life

How to Clean	10
Troubleshooting	11
Circuit Breaker Protection	
Specifications	Back Cover

Safety Precautions

Please observe these precautions fully

For your safety and in order to prevent the product damage and the danger to the users and others, please read the following instructions strictly.

- The signals indicate harm and damage when the product is used wrongly.

 WARNING Indicating " it may cause severe injuries and death."	 CAUTION Indicating " the user may get injured or the product may cause the property damage."
--	---

- The symbols indicate specified items that must be followed.

 This symbol indicates prohibition.	 This symbol indicates mandatory.
--	--

WARNING



- This appliance is not intended for use by persons (including children) with reduced physical, sensory or mental capabilities or lack of experience and knowledge unless they have been given supervision or instruction concerning use of the appliance by a person responsible for their safety.
Children should be supervised to ensure that they do not play with the appliance.
- Never touch food in the Jar by hand. Always use a spatula.
- Never open or close the lid when the Jar is placed on the motor housing. Especially never open the lid as the blade is still moving for a while after switching off.
- Do not push the safety lock pin with any implement, stick etc.
- To prevent electrical shock, do not let the motor housing come in contact with water or any other liquid.
- Never leave the appliance running unattended.
- Do not bend or put excessive pressure on the power cord or let the cord hang over the edge of the table / slab or touch any hot surface. Do not run the appliance with a damaged power cord.
- Do not use any attachment other than those provided or recommended by the manufacturer. It may cause hazards.
- Do not operate the appliance if it malfunctions, or is damaged in any manner.
- Never attempt to repair the appliance yourself or allow any unauthorised person to do so.



- If the supply cord is damaged, it must be replaced by the manufacturer, its service agent or similarly qualified persons in order to avoid a hazard.
- Make sure that the voltage and the plug type of the appliance are the same as your supply.

- Keep clean to avoid foreign particles deposit on the safety lock pin of the motor housing and the bottom of Jar handles.
- Keep hands and utensils away from the moving parts, while the appliance is in operation to prevent the possibility of severe personal injury or damage to appliance. The Spatula may be used to stir the ingredients only when the machine is switched OFF.
- Keep the appliance away from the source of heat like gas or electric stove.

CAUTION



- Do not place the appliance on an unstable surface.
- Do not run the appliance without assembling the Jar unit.
- The Chutney Jar is fixed with Chutney Blade permanently. Do not attempt remove these.
- Do not run the appliance with the Jar empty.
- Never load the Jar with ingredients beyond the maximum level (See "Guide to Function" on P.8 for maximum capacity details).
- Do not move the appliance during operation.
- Do not use the power cord if the plug does not fit in the socket.



- Ensure that the correct blades are assembled on the correct Jar (See "Parts Identification" on P.4).
- Care shall be taken when handling the sharp cutting blades, emptying Jars and cleaning them.
- Before plugging in / out, make sure that the switch is off and each part is securely set in place.
- Be sure to switch off the appliance and unplug after each use.
- To disconnect the power supply, switch off, grip the plug and pull it from the wall outlet. Never pull the cord.
- Switch off the appliance and disconnect from supply before changing attachment or approaching parts that move in use.

Difference among three models

	MX-AC300	MX-AC220	MX-AC210
JAR UNIT	○	—	○
MILL JAR UNIT	○	○	—
CHUTNEY JAR UNIT	○	○	○

Parts Identification

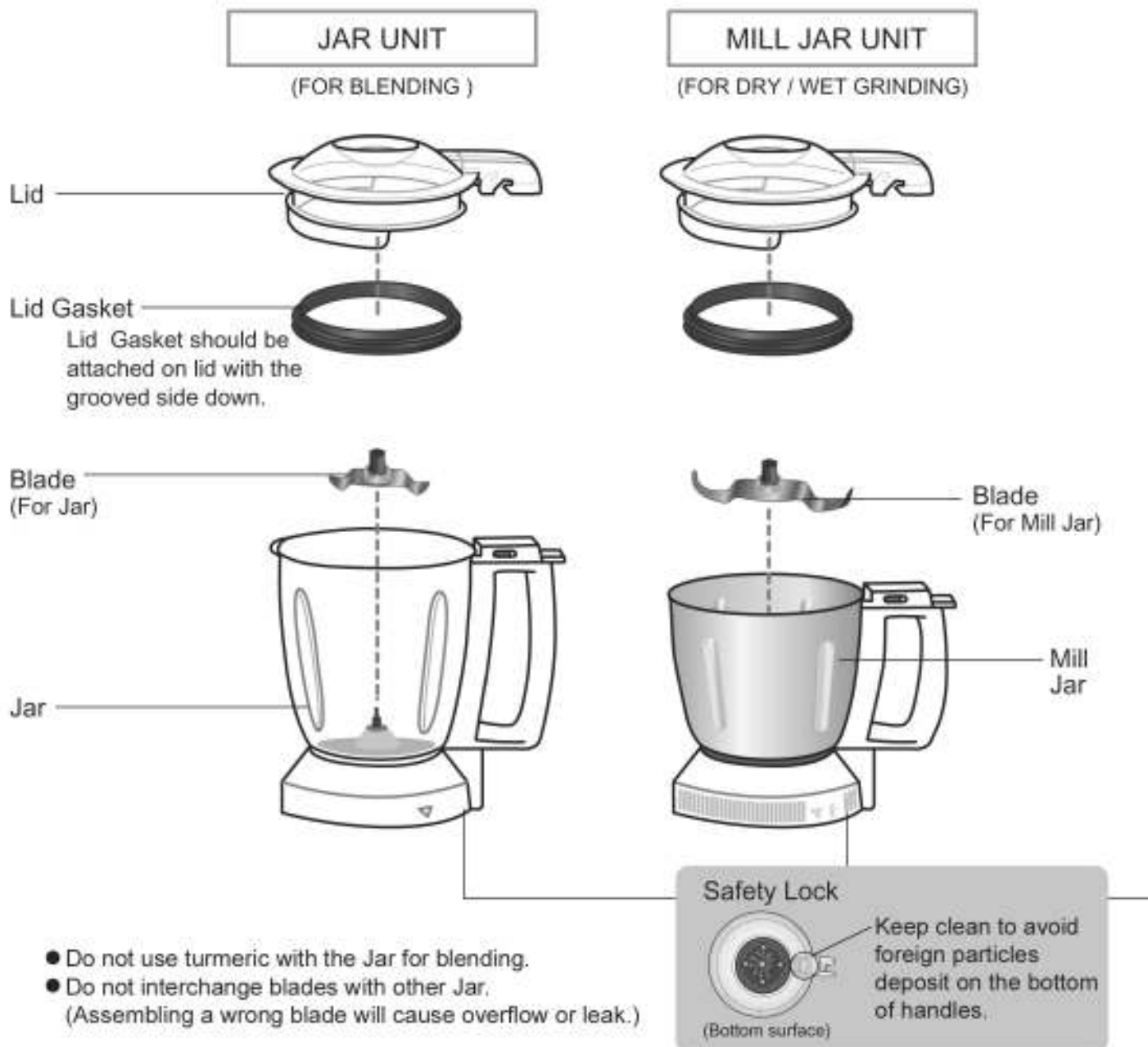

Safety Lock

The safety lock has been designed to prevent the appliance from switching on when the Jar is not properly in place. Do not push the safety lock pin with any implement, stick etc.

Keep clean to avoid foreign particles deposit on the safety lock pin.

CHUTNEY JAR UNIT (FOR DRY / WET GRINDING)

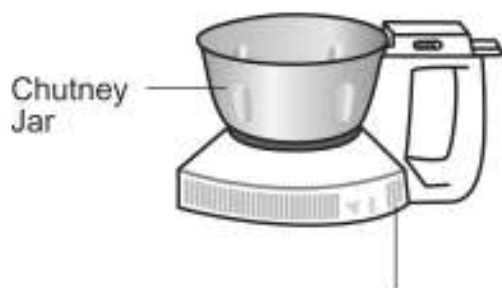

- The Chutney Blade is fixed permanently. Do not attempt to remove the blade.

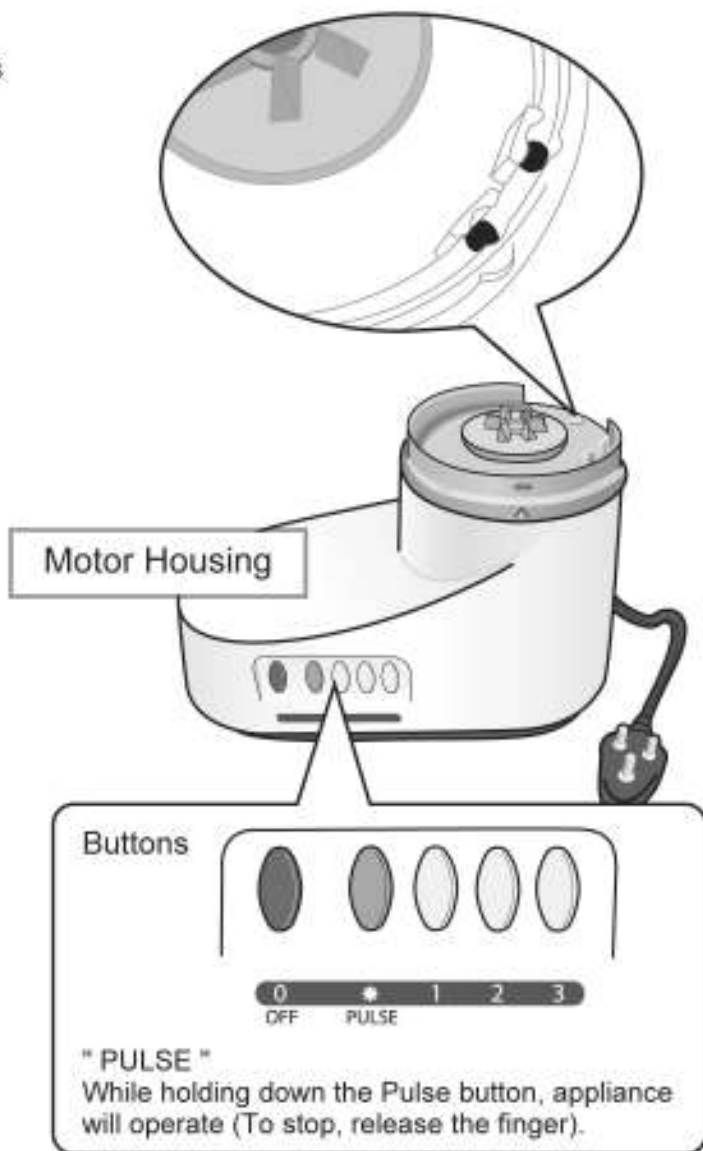

ACCESSORIES



To use for the Jar and the Mill Jar.

Whipping Plate

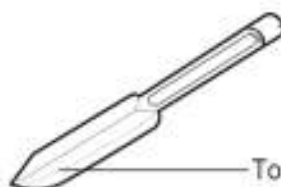

To use for disassemble the blades or Whipping Plate.

To use for removing contents from the Jar.

Spatula

How to Assemble / Disassemble

Blade (Jar, Mill Jar, Whipping)

- 1 Put the blade inside of the Jar.



- 3 Tighten the blade knob (black) with the spatula (anti-clockwise direction).



- 2 Hold the Jar coupler at the bottom.

● To disassemble, reverse the assembly instructions.

Lid

Disassemble



● In case the lid is forced to open without pushing the button, the handle may break.

How to Use

1 Put ingredients.

Make sure the buttons are not pressed down on the Motor Housing.

2 Put the lid on the Jar first, then set it on the Motor Housing.

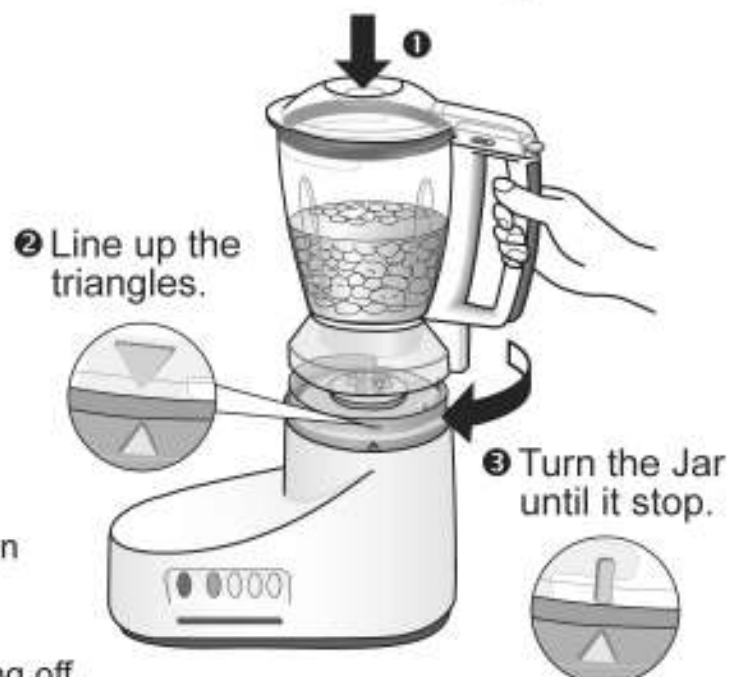

Never open or close the lid when the Jar is placed on the Motor Housing as the blade is still moving for a while after switching off.

Assemble



- Set a hook on and make sure the lid is locked.

CAUTION

- Please clean the jars and lids before using.
- Please run the appliance for short duration. Pause for 3 minutes and then resume.
- Do not overload the appliance with ingredients (See to "Guide to Functions" on page 8).
- Do not run the appliance without any ingredients in the Jar or without the Jar unit.
- Do not put a spoon etc. in the Jar.
- Do not put hot ingredients in the Jar.
- Use the recommended Jar only for the recommended functions like blending and whipping etc. (See to "Guide to Functions" on page 8).
- Blades are very sharp. Handle them carefully.
- Do not use turmeric with the Jar for blending.

- 3** Plug in and press the button.
While operating, hold the lid down.



When adding extra ingredients, turn off the switch. Remove the Jar from the Motor Housing and repeat step 1~3.

- 4** Press the OFF button and remove the Jar.
Then take out the contents.



After use unplug.

Guide to Functions

Jar Type	Function	Example	Minimum Level	Maximum Level
Jar (Not available for MX-AC220)	Whipping	Cold coffee, Butter milk, Lassi, Eggs, Cream	Up to the blade	$\frac{2}{3}$ of the Jar
	Blending & Liquidizing	Fruits Juices, soups	Up to the blade	$\frac{2}{3}$ of the Jar
Mill Jar (Not available for MX-AC210)	Dry Grinding	(Max.80g) Rice , Pulses, Masala, Dry spices, Sugar, Bread crumbs, Nuts, Roasted coffee beans	Up to the blade	$\frac{1}{2}$ of the Mill Jar
	Wet Grinding	Soaked Dal or Rice, Coconut, Onion, Masala paste etc.	Up to the blade	$\frac{1}{3}$ of the Mill Jar
	Mincing	Raw meat, Kababs and Meat fillings	Up to the blade	$\frac{1}{3}$ of the Mill Jar
	Grating	Onion, Carrot, Cabbage, Other vegetables	Up to the blade	$\frac{1}{2}$ of the Mill Jar
* Chutney Jar	Dry Grinding	Sugar, Coffee beans, Spices, Condiments, Nuts	2tbsp (Coffee beans)	$\frac{1}{2}$ of Jar level
	Wet Grinding	Masala paste, Onion etc.	1 $\frac{1}{2}$ tbsp heaped ingredients and a little water	$\frac{1}{2}$ of Jar level
		Ginger, Garlic Paste	1 $\frac{1}{2}$ tbsp heaped ingredients and a little water	$\frac{1}{2}$ of Jar level
		Poppy Seed Paste	1 $\frac{1}{2}$ tbsp heaped ingredients and a little water	$\frac{1}{2}$ of Jar level
		Poppy Seed & Cashew nut Paste	1 $\frac{1}{2}$ tbsp heaped ingredients and a little water	$\frac{1}{2}$ of Jar level
		Coconut Chutney	1 $\frac{1}{2}$ tbsp heaped ingredients and a little water	$\frac{1}{2}$ of Jar level
		Mint/ Coriander Chutney	1 $\frac{1}{2}$ tbsp heaped ingredients and a little water	$\frac{1}{2}$ of Jar level

* The Chutney Jar is used for dry and wet grinding such as small quantities of masala powders, pastes and chutneys. When grinding very small quantities, use Speed 1 and rest the mixer at short intervals.

Remark

- Use the Pulse when whipping cream and ensure that it is well chilled.
 - Take extra care not to overwhip cream or drinks containing cream, which causes cream to separate into butter and whey.
 - A minimum of 5-6 egg whites are needed to whip up to a stiff consistency. Ensure that the Jar and blade are totally dry and free of grease or fat. Even a tiny of yolk prevent whites from whipping up stiffly.
-
- Avoid overblending fruits like grapes to prevent the seeds from getting crushed.
-
- The ingredients should be free from moisture. Dry them in sunlight or roast before grinding.
 - Add harder ingredients like turmeric and dals first to grind masala to a uniform blend.
 - For tough grinding, rest the mixer for short intervals while operating.
 - Break turmeric into smaller than 1 cm before grinding. Always grind turmeric with other ingredients.
-
- Using the Pulse or Speed 1 first to crush the ingredients. Add water as required and grind at Speed 2. Stop the mixer and scrape the paste with a spatula in between grinding. Replace the lid and grind till done.
-
- Use the Pulse for mincing.
 - Overmincing will turn the mince into a paste.
-
- Use the Pulse and avoid over mincing.
-
- All ingredients must be dry and free from moisture.
-
- When grinding a masala paste which contains dry and moist ingredients (Cumin, Coriander seeds, Dal, ginger, garlic and green chillies), add the dry ingredients in the Chutney Jar first and powder them. Then add moist ingredients like green chillies, ginger, garlic and a small quantity of water and grind to a paste.
 - Slice the ginger, and peel the garlic. Place them in the Chutney Jar. Use the Pulse to crush them, then add a small amount of water and grind to paste.
 - Lightly roast the poppy seeds and grind them to powder. Then add a little water and grind them to paste.
 - Roast the poppy seeds lightly. Place them in the Chutney Jar and grind them to powder. Then add a little water and grind to paste.
 - Place the ingredients in the Chutney Jar. Use the Pulse to crush them. Then add a little water and grind to paste.
 - If the recipe does not contain any thick ingredients like coconut or roasted gram, it's not necessary to add water. Place the ingredients with salt to taste in the Chutney Jar (The salt brings out the moisture in the leaves and promotes smooth grinding of the chutney). Use the Pulse to crush and grind to paste.

How to Clean

Attention

- Unplug and handle the blades with care.
- Use liquid soap mixed with water and Soft Sponge.
Do not use benzines, thinners, cleansers, scouring pads etc.. (Damaging the surface)
- Do not use hot water over 60°C or dishwasher.

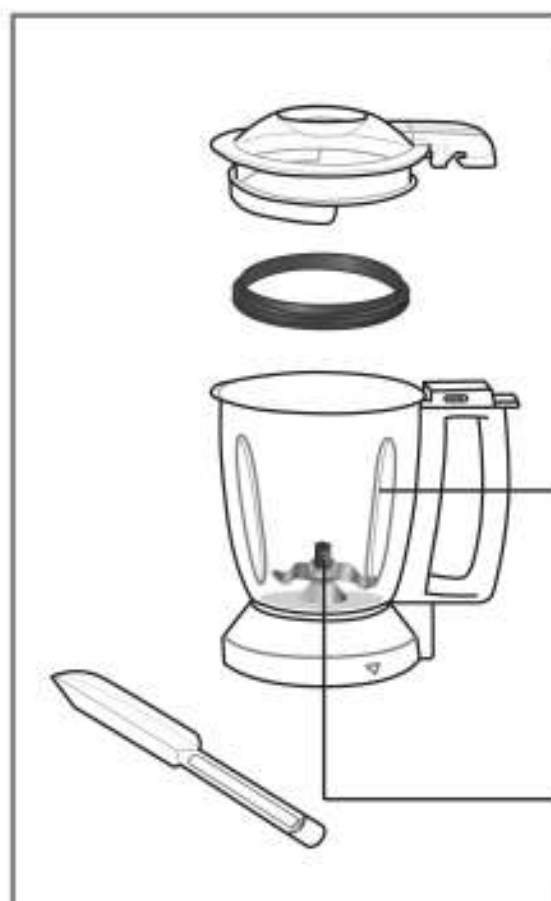

Wash with soft sponge.

To prewash before using Jar
(Prewashing does not apply to the Mill Jar and the Chutney Jar.)

- 1 Pour 250 ml of lukewarm water in the Jar.
- 2 Press button(*) and operate the appliance for about 10 seconds.
- 3 Switch off and unplug.
- 4 Disassemble and throw away water.



To clean blades



Wash by a brush with handle.
Handle them carefully to avoid cutting hand or fingers.



Wipe the Motor Housing with well wrung damp cloth.

Troubleshooting

If...	Possible cause	How to fix
Unit can not be turned on. Unit stops operation.	<ul style="list-style-type: none">• Is Jar set properly?• Is the lid set properly?	<ul style="list-style-type: none">• Turn the Jar until it stops.• Push lid down completely. (P.7)
Unit does not operate when turned on.	<ul style="list-style-type: none">• Is the plug connected properly?• Aren't ingredients stuck?	<ul style="list-style-type: none">• Plug in properly.• Remove all the ingredients once and put them back in the Jar.
Unit stops operation during use.	<ul style="list-style-type: none">• Is circuit breaker protection active?<ul style="list-style-type: none">• Too much ingredients.• Hard ingredients.• Unit makes too much sound or vibration.	<ul style="list-style-type: none">• Follow the instruction for "Circuit Breaker Protection" (See below)
Ingredients leak from top.	<ul style="list-style-type: none">• Is the Lid Gasket set?	<ul style="list-style-type: none">• Set the Lid Gasket properly.

Circuit Breaker Protection

1 When circuit breaker automatically stops motor due to overload, press the OFF button.

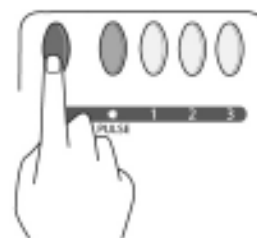

2 Remove the Jar unit and reduce its contents to half.



3 After 2 or 3 minutes, tilt the Motor Housing and push the button of the bottom surface. The appliance is now ready for reuse.

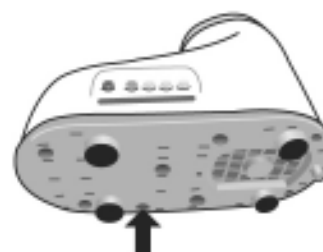

Specifications

Model No.		MX-AC300	MX-AC220	MX-AC210
Power Supply		230 V ~ 50 Hz		
Power Consumption		550 W		
Protection		Circuit Breaker		
Rating		30 min		
Material	Housing	Plastic (ABS)		
	Jar	Plastic (Polycarbonate)	Not Available	Plastic (Polycarbonate)
	Mill Jar	Stainless Steel		Not Available
	Chutney Jar	Stainless Steel		
	Lid	Plastic (Polycarbonate)		
	Blade	Stainless Steel Hard Type		
Speed Control		3 Speed with 1 Pulse & 1 Off Button (piano Type Buttons)		
Capacity				
Jar	Max.	1.0 L (Wet only)	Not Available	1.0 L (Wet only)
Mill Jar		0.5 L (Dry) / 0.3 L (Wet)		Not Available
Chutney Jar		0.2 L		
Weight		4.6 kg	3.9 kg	3.9 kg
Accessories		Spatula, Whipping Plate		

Panasonic Home Appliances India Co., Ltd.

N.H.No.5, Sholavaram Village, Ponneri Taluk, Chennai - 600 067

Web Site : www.panasonic.co.in